

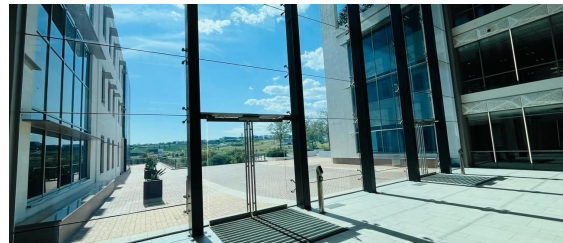

**Midrand, Gauteng**

**920m2 Prime Office Space to Let in Exceptional Waterfall Building**

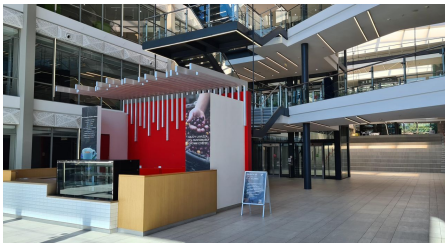
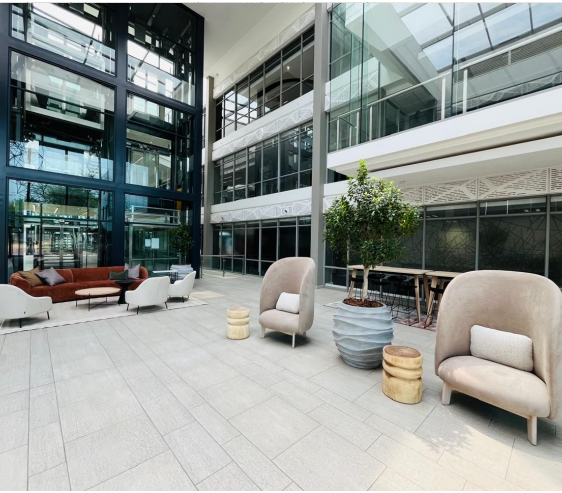

This exceptional building, previously home to logistics giant, Transnet, is situated in the heart of the Waterfall precinct, which stands as a flourishing epicenter of business and commerce, playing host to an impressive array of multinational powerhouses. It boasts A-Grade status, and has full back-up power and water, and is directly across from the Waterfall Lifestyle shopping centre. It is on major public transport routes, and quick to get to from major highways and arteriole roads.

This space takes up a portion of the first floor, and offers various internal and external boardrooms, meeting rooms, large open-plan areas, training rooms, private offices, kitchen and pause areas, and more. There is a staff restaurant and coffee shop on the premises. A must-see for any ambitious business wanting to be with corporate superstars such as Dimension Data, Accenture, Isuzu Motors South Africa, Decision Inc., Boehringer Ingelheim, Ericsson, Wood, PWC, Deloitte, and many more.

**R202,400 PM**  
**excl. VAT & Utilities**  
price per m<sup>2</sup>: R220

**FEATURES**

Gross Monthly Rental Available From	R202,400 Excl. VAT
Lease Period	Immediately
	36 months
Building Size (m <sup>2</sup> )	920
Land Size (m <sup>2</sup> )	920
Zoning	Commercial
Security	Yes
Open Parkings	4
Power 3 Phase	No
Air Conditioning	Yes

**WEB REFERENCE NO.**  
**COM21246**

Go to [3cubeproperty.co.za](http://3cubeproperty.co.za)  
for more information about this property



**CONTACT**  
**TESSA JOSEPH**

☎ 078 289 3902 / (010) 3006441

✉ [tess@3cubeproperty.co.za](mailto:tess@3cubeproperty.co.za)